

AFTER SALES SERVICE

Warranty

- Please read carefully
Keep in a safe place
- Please confirm the dealer name and date of purchase
- The manufacturer's guarantee period of PAIMORE Digital Perm III AL is 12 months from the date of purchase. Please note, Rods and Rod lines are guaranteed for 6 months from the date of purchase. Damage or malfunction caused by negligence, abuse, neglect, unauthorised repair, or any other use not in accordance with the Operating Instruction Manual is not covered

If your PAIMORE Digital Perm III AL requires service Please read this manual carefully and refer to the Troubleshooting section. If you still require service, please call the Distributor.

- Under guarantee period
Please call the Distributor. Based on the condition, the appliance will either be serviced or replaced.
For more detail, please see the warranty.
- If the supply cord is damaged, it must be replaced by the manufacturer, its service agent or dealer to avoid a hazard.



PAIMORE CO.,LTD.

HEAD OFFICE 5-28 SHINMACHI SAKAI-WARD SAKAI-CITY OSAKA 590-0079 JAPAN
PAIMORE OSAKA STUDIO TEL.072(221)1888 FAX.072(233)5192
TOKYO BRANCH-PAIMORETOKYO STUDIO TEL.03(5391)4818 FAX.03(5391)0228
SAPPORO OFFICE TEL.011(522)1887 FAX.011(522)1896
NAGOYA OFFICE TEL.052(569)1480 FAX.052(569)1484
HIROSHIMA OFFICE TEL.082(236)6549 FAX.082(236)6534
FUKUOKA OFFICE TEL.(092)437-8321 FAX.092(437)8320
PAIMORE KOREA SEOUL STUDIO TEL.0502(808)8118 FAX.02(549)8148
PAIMORE HONG KONG STUDIO TEL.852(2421)8360 FAX.852(2421)7779

Home-page address <http://www.paimore.com>



PAIMORE Digital Perm III AL

Operating Instruction manual

● INDEX

- Safety Instruction and Precautions 1~2
Part Names 3
Basic Operating Procedure 4~5
Precaution of using Rod Line 6~7
Product Specification 8
Troubleshooting 8
After Sales Service 9

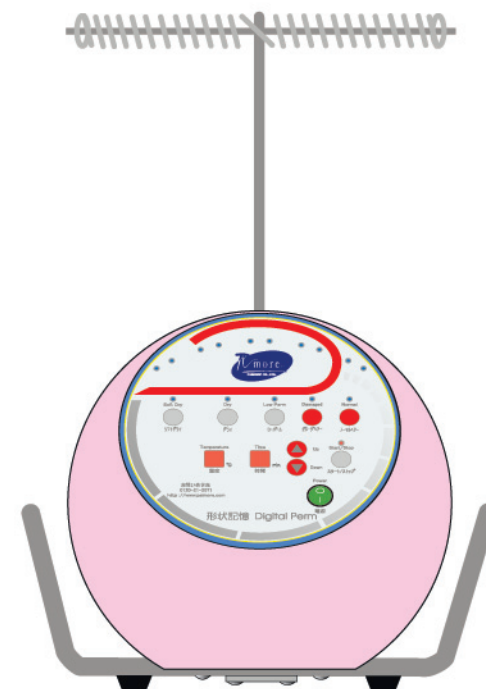

PAIMORE CO.,LTD.

IMPORTANT SAFETY INSTRUCTIONS and PRECAUTIONS-Please observe fully

Thank you for purchasing the PAIMORE Digital Perm III AL

- In order to prevent harm or injury to those using this appliance or to any other persons and/or property please be sure to read this instruction manual carefully before operating this appliance.
- Follow these safety instructions and use the appliance correctly to prevent injury, death, and material damage. Possible consequences of incorrect usage are laid out in the following pages, each marked with a sign according to the degree of danger.
- Do not use this appliance for other than intended use. The manufacturer is not responsible for any injury or damage resulting from incorrect use or handling (see also Guarantee Terms).
- Please retain these instructions for future reference.

	Warning	This sign warns of possible death or serious injury to persons and/or property.
	Caution	This sign warns of possible damage or injury to persons and/or property.

■ The following signs indicate the kind of instructions you should follow

	Caution: This sign is intended to alert the user to the presence of important operating and maintenance (service) instructions in the Operating Instruction Manual.
	This sign indicates actions which are prohibited.
	This sign indicates action to be taken.

Warning

Handling: Never try to disassemble, repair or remodel the PAIMORE Digital Perm III AL
For power plug, power cord and rods:

- Never do anything that might cause damage to the power plug or cord. Do not dismantle it, modify it, place hot objects near it, excessively bend it, twist it, stretch it, tear it, place heavy objects on it or bundle it together. Do not use with a damaged power cord or plug. If used when damaged then electric shock and fire may result. If either the power cord or plug is damaged it must be replaced by the manufacturer, its service agent or dealer to avoid a hazard.
- Do not handle the power plug and cord with wet hands. This may result in electric shock.
- Use a single outlet that matches the power rating of the appliance. Heat generated when plugging in multiple appliances into one outlet may result in fire.
- Do not use tangled power cords or extension cords. Using other electric fittings (such as an adaptor) with tangled cords may cause a fire.
- Always plug directly into a wall outlet. Never use with an extension cord or re-locatable power tap (outlet/power strip). Overloading may result in the cord overheating and catching fire.
- Clean dust from power plug regularly. Occasionally unplug the power plug and use a dry cloth to clean off the dust around the power outlet. If the surrounding is dusty, humid, or oily, the dust on the power outlet may become moist and short circuit the outlet to cause a fire or result in electric shock.
- Please ensure that the plug is correctly inserted into the power outlet. Always insert the power plug all the way in. If the plug is inserted improperly it may cause electric shock or generate heat resulting in fire. Do not use a damaged plug or a connection in a loose outlet.
- When cleaning the PAIMORE Digital Perm III AL, disconnect the power plug first.
- Do not rinse rods with water, only use a dry cloth for cleaning. If liquid penetrates inside the rods then this may cause damage and breakdown.

For the maintenance of the rods, rod lines and main parts contact your Distributor.



CAUTION/ATTENTION Wall outlet and power cord

- Ensure power cord is unplugged when moving this appliance.
- When unplugging the appliance pull the power plug - not the cord.
- To disconnect the appliance, turn off all controls then remove the power plug from the power outlet.

When the appliance is not in use, unplug the power plug from the power outlet.

Handling and Location during Use

To unplug, ease power plug gently from the power outlet. Do not forcibly pull the plug from the power outlet.



Do not allow panel and power switch to come into contact with water.

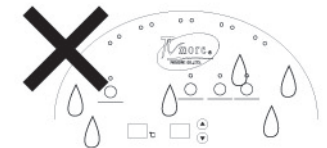

Do not place the appliance on unstable surfaces or surfaces that can be affected by heat. There is danger of a fire hazard.



Do not forcibly push nor pull this appliance as it may fall and cause injury.



If the appliance overheats, gives off smoke or an unusual odour, makes an unusual sound, immediately turn off the appliance and disconnect the power plug from the power outlet. After the problem has subsided contact your Distributor. Never attempt to repair the PAIMORE Digital Perm III AL yourself as there may be risk of electrical shock and/or fire.

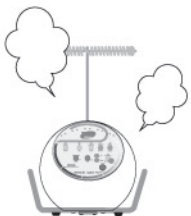

PART NAMES

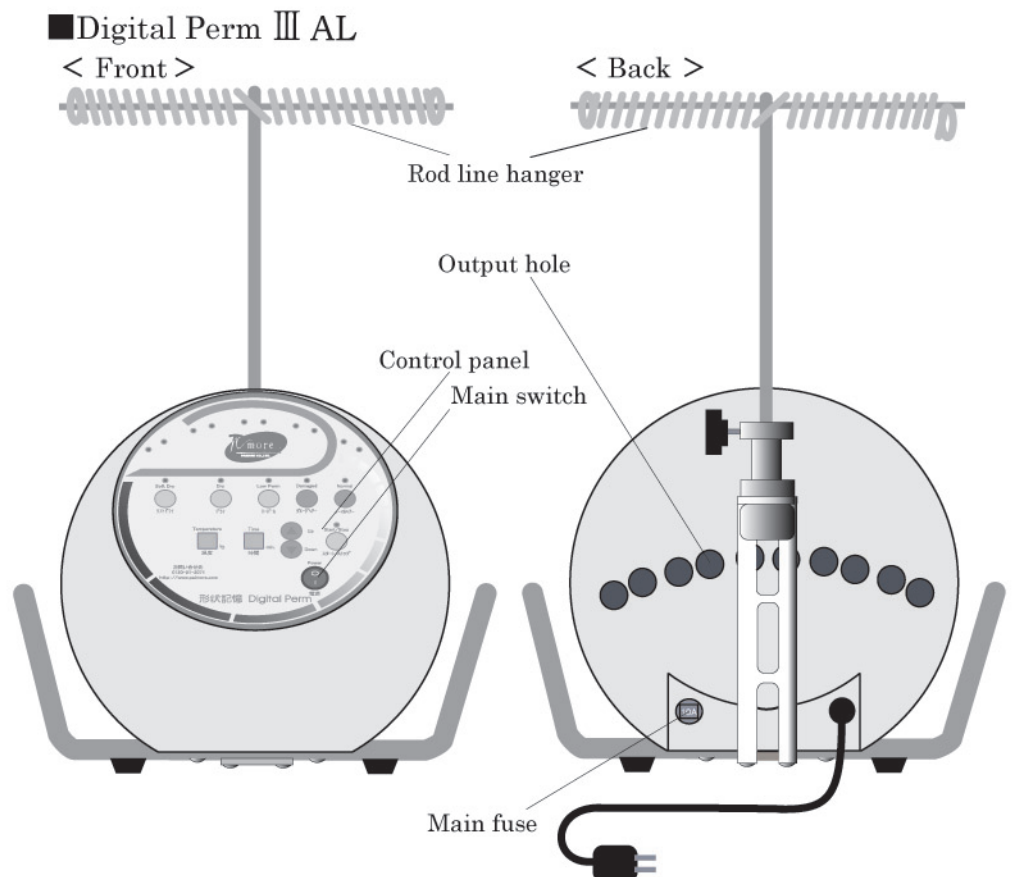

■ Rod line

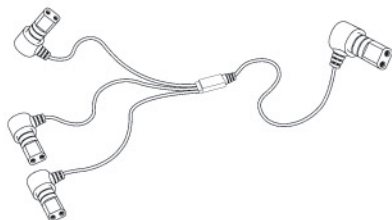

- Must be cooled before unplugging the rod line from the rods.
- To unplug the rod line, you must pull straight. Do not twist.

■ Rod



- Do not wash rods with water.
- For cleaning, wipe with dry cloth.
- Breakdown may occur if water gets into the rod's body.

DIGITAL PERM BASIC PROCEDURE

1. Insert the power plug into the power outlet.

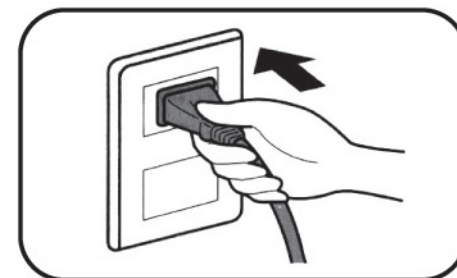

2. Wind up hair to the rods.

3. After winding, connect the rod line to the rod.
※Make sure that all the rod lines are correctly connected with the rods.

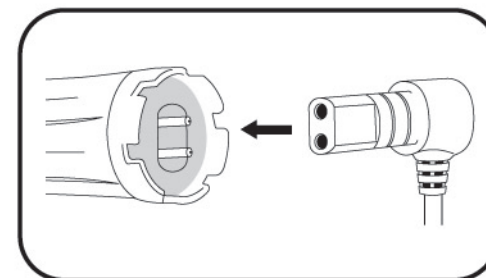

4. Turn on main power switch.

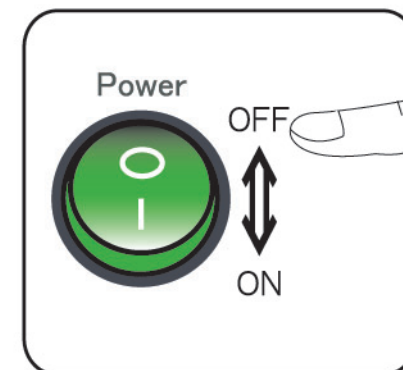

5. Select mode

Select mode based on client's hair condition.

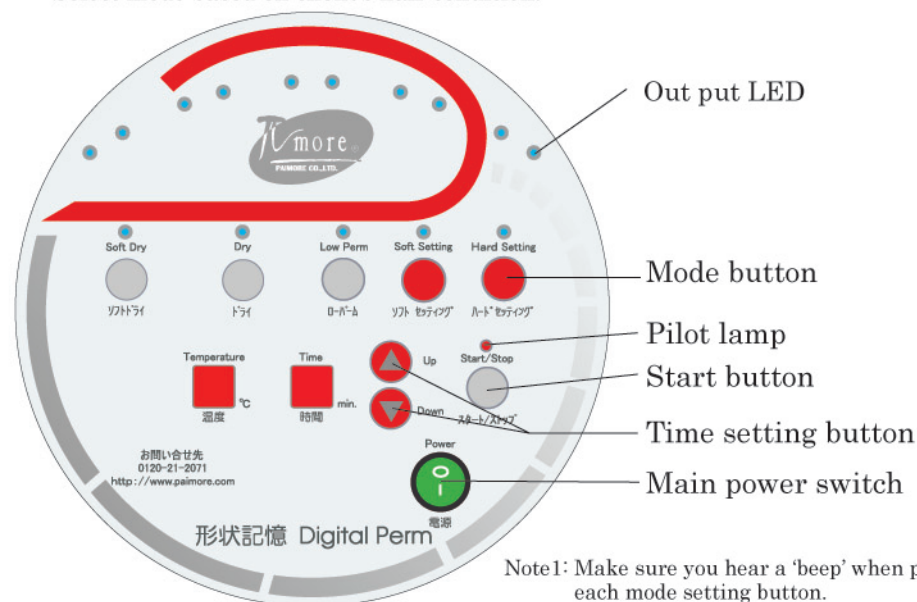

Note 1: Make sure you hear a 'beep' when pressing each mode setting button.

Note 2: Once you press the start button, you cannot change to the other settings.

■ Perm Mode

	Basic setting of temperature	Basic Time
Low Perm	55°C~60°C	10~20 minutes
Soft Dry	45°C	10~20 minutes
Dry	50°C	10~20 minutes

■ Setting Mode

	Basic setting of temperature	Basic Time
Soft Setting	70°C~80°C	10~20 minutes
Hard Setting	75°C~85°C	10~20 minutes

! Please adjust time based on client's hair condition.

6. After selecting the mode, press start button.

- Please confirm that the pilot lamp is on.
- ⚠ You will hear a beep when pressing each mode button.
- After 5 minutes please confirm that the rod's temperature has increased.

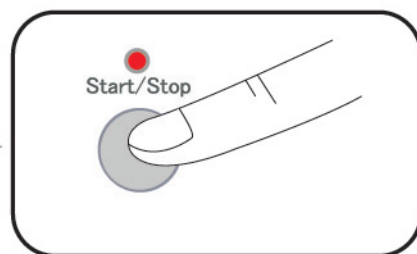

7. When the process is finished

- Appliance will beep continuously.
- Allow rods to cool down for 5 minutes. Before detaching the rod lines, make sure that all the rods have cooled down.

Precaution of using Rod Line

① Insert Rod Line by making line to go upward. Always loosen the line and give the line to play.



② When hooking up the Rod Line to the Antenna Spring, be sure to hook three-pronged line part gently.

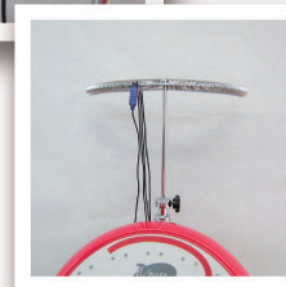
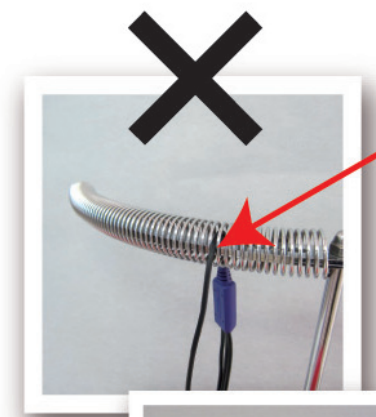
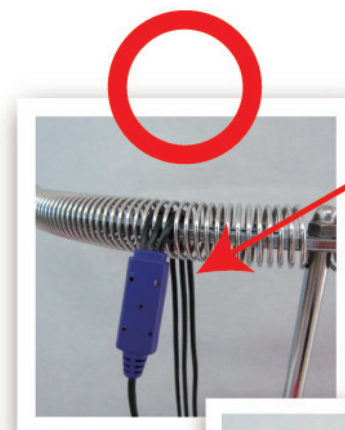

③When you pull Rod Line, be sure to unhook the line before pulling.

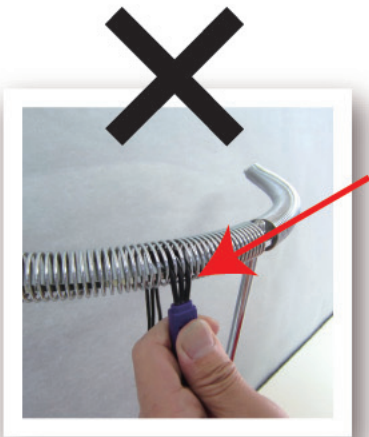
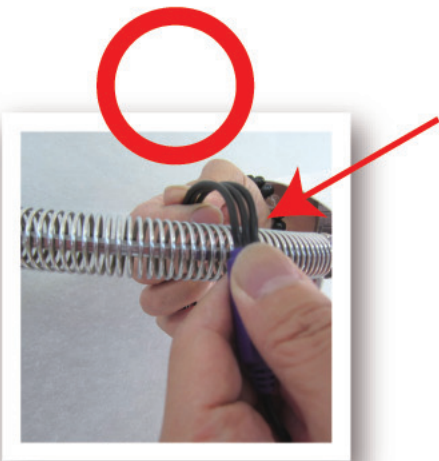

④Do not connect blue plug into machine.

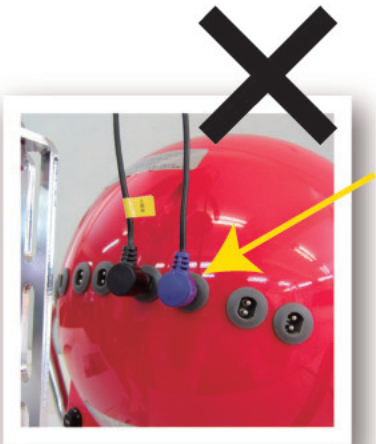

● PRODUCT SPECIFICATION

	Digital Perm Ⅲ AL
power	220V-240V AC
frequency	50/60Hz
power consumption	530W
weight (including accessory)	1 1kg
measure	width380mm×length385mm×high295mm
CE	

CAUTION

- When detaching the rod lines.
Make sure that all the rods have cooled down.
- When maintaining the rods.
Use a dry cloth to wipe the rods. Do not wash rods with liquid. If liquid gets inside the rods, it may cause breakdown.
- How to maintain the PAIMORE Digital Perm III AL.
Please wipe with a soft cloth. If required, use neutral detergent.
- This appliance is not intended for use by persons (including children) with reduced physical, sensory or mental capabilities, or lack of experience or knowledge, unless they have been given supervision or instruction concerning use of the appliance by a person responsible for their safety.
- Children should be supervised to ensure they do not play with the appliance.

Troubleshooting

Condition	Possible Cause	Possible Solution
● Power does not come on	● Appliance is unplugged. ● Power failure. ● Blown fuse.	● Check whether the power plug is inserted completely. ● Replace.
● Rod temperature does not increase	● Rod lines are not inserted to the rods correctly. ● Rod is faulty. ● Rod lines are faulty.	● Check that the rod lines are correctly connected to the rods.
● Out put LED is blinking or fading out.	● Main part is faulty. ● Rod is faulty. ● Rod lines are faulty.	● Remove rod lines from rods and turn on the switch.